



# Horsforth Newlaites PTA

Have fun and raise funds — 2021 / 2022

AGM October 11, 2021 all welcome!

# Our PTA



1. Introductions
2. The role of the PTA
3. The benefits
4. Business or skills to support the PTA
5. The need for parents to engage and help
6. Your School Lottery
7. Fundraise while your shop!
8. Most importantly it is fun!

# 01



# PTA Committee Team Introductions

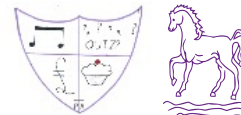

**James Cowell**

Chair

A daughter, and a son at Newlaithes.



**Helen Finnerty**

Deputy Chair

A daughter at Newlaithes.



**Claire O'Neill**

Treasurer

A son, and two daughters at Newlaithes.



**Kelly Ghosal**

Deputy Treasurer

Two son, one at Newlaithes, one at High School..



**Claire Simpson**

Secretary

Two sons, one at Newlaithes, one at High School.

**In October 2021 the PTA will need to elect a new committee**

Every parent, carer, guardian and teacher is automatically a member of the PTA! Registered with the Charity Commission as [1156167](#)



# 02

The role of the PTA

# The role of the PTA

The PTA raises money for our school to enhance the learning environment for all students and teachers. We run numerous events throughout the year from 'Grow-a-pound' to 'Ice-Cream Fridays', and Bun Sales, Discos and School Fairs!

With government cuts to schools it is more important than ever that we are able to help raise funds for Newlathes. Without your help we will be unable to support the maintenance and enhancement projects we are proud to have delivered over the years, such as:

- Smartboards for all classrooms
- Playground upgrades and Trim Trails for KS1 & KS2
- Wooden pavilions
- Cameras for all classes
- School library improvements and systems
- Main stage and P.A. system for the main hall
- Peace Garden. And more!

Every parent, carer, guardian and teacher is automatically a member of the PTA! Registered with the Charity Commission as [1156167](#)

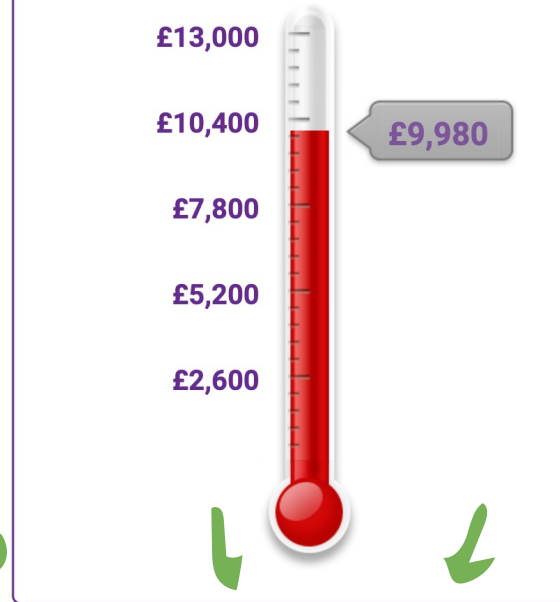

→ LET'S WORK ←  
→ TOGETHER ←  
↑ ↓

# OVERVIEW OF THE RESULTS

Survey of 336 schools



## 94%

of schools said that COVID-19 had a 'somewhat negative' or **'very negative'** impact on their fundraising.



## 98%

of schools reported having to cancel fundraising events as a result of COVID-19



## 80%

of schools stated that (apart from their lottery) they had been unable to continue ANY form of fundraising



## 96%

of schools expect COVID-19 to continue affecting their ability to raise funds in the next academic year



## 80%

of schools said that their lottery had helped them to keep funds coming in during COVID-19





# 03

The benefits



# The benefits

- **For our children and for future pupils:**
  - Pupil enrichment gives children the opportunity to take ownership and responsibility while learning about business and enterprise.
  - Get to know everyone involved and feel a sense of pride and achievement.
  - Benefit directly from School Swim Gala, Football Kits, really fun events, classroom equipment, playground activities... and much more!
- **The sense of community it creates:**
  - The feeling of belonging not only for the parents involved, but also the children.
- **The role modelling it provides:**
  - Children feel proud of their parents for leading by example and supporting their school - they feel engaged with teachers and enjoy backstage pass activities!
- **The relationship building:**
  - Particularly for those new to the school – meet new friends through volunteering – build relationships with parents and teaching staff too.
- **It's Fun!**

We believe everybody has a contribution to make - everyone is welcome to join.



# 04

Businesses or skills to  
support the PTA

Do you have a business or skill that would be really helpful to support the PTA?

Together we can do so much more – using the skills and businesses in our community.





# 05

The need for parents to  
engage and help

# Every bit of help people can offer really does add up

- Honestly - we cannot do it without you.
- Don't wait to get involved!
- Have your say on which events and what we fundraise for.
- Commit to as much as you can manage: everyone is in the same position and respects family and work commitments come first.
- Many parents and teachers help on an event basis – so step up to co-ordinate, plan and/or help on the day for on event during the year, whilst others love to get involved throughout the year.
- Committee members would ideally commit to the year or 'job share' with a friend.
- Volunteers are required for many skills, eg: Planning, co-ordination, class reps (spread the word in your class), setting up and clearing away, door monitors at discos, baking, marketing, prop design, making gifts, shopping, gift aid and charity admin, website and social, first-aiders, ice cream sellers, gardeners, builders!

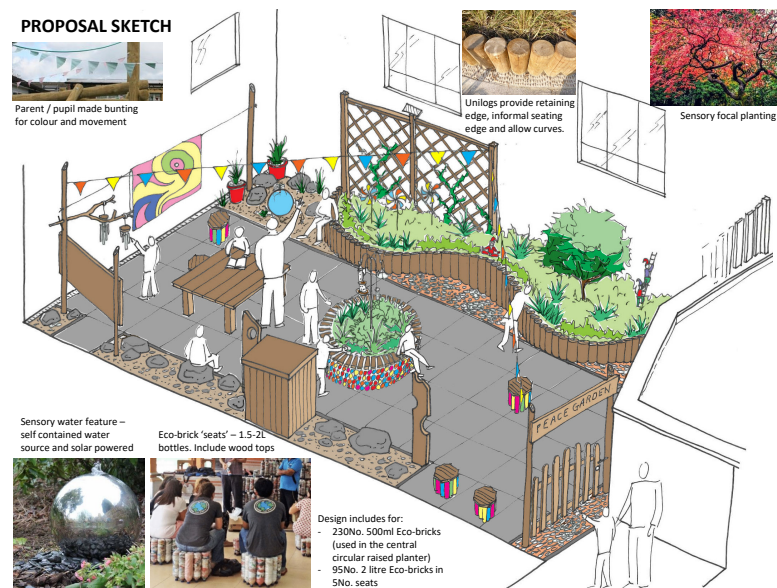

Above: what we can achieve – last year the PTA helped provide a Peace Garden in the playground.



06

Your School Lottery



# Your School Lottery

<https://www.yourschoollottery.co.uk/lottery/school/horsforth-newlaithe-primary-school>



**YOUR  
SCHOOL  
LOTTERY**

# 07



Fundraise whilst you shop!



# Fundraise whilst you shop



<https://www.easyfundraising.org.uk/causes/horsforthnewlaithe/s/>

- Use easyfundraising to shop with over 3,600 retailers including Amazon, Argos, John Lewis, ASOS, Booking.com, eBay, Boden, and M&S.
- Every time you shop, you'll raise a free donation for **Horsforth Newlaithe** Primary School PTA - Leeds every time, its that easy!



<https://smile.amazon.co.uk/ch/1156167-0>

- AmazonSmile is a website operated by Amazon with the same products, prices, and shopping features as Amazon.com.
- The difference is that when you shop on AmazonSmile, the AmazonSmile Foundation will donate 0.5% of the purchase price of eligible products to Horsforth Newlaithe Parent Teacher Association.



[www.easy2name.com](http://www.easy2name.com)

- For every order placed by post, phone or at [www.easy2name.com](http://www.easy2name.com) from our group Horsforth Newlaithe PTA we will receive 20% back in commission!
- Simply select Horsforth Newlaithe PTA at checkout in the drop down which says:
- "If you are part of a fundraising group, please select it from the list below." and click Select Group.



# AGM

Meet us at the AGM!

# The next AGM will be online - October 11th at 6pm, 2021.

<https://meet.google.com/cwe-sbhs-qbw>

At this meeting we will be electing the  
new committee members and making  
plans for the year.

Registered with the Charity Commission as [115616Z](#)

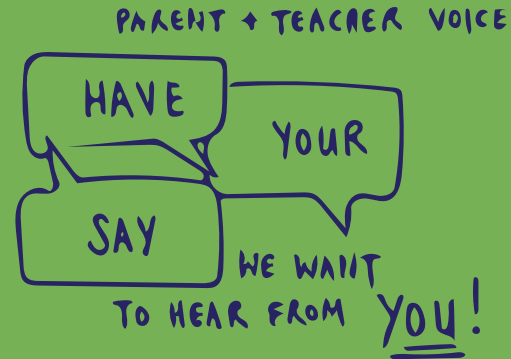

- ✓ Alongside committee roles there are lots of other smaller jobs that we always need help with – helping to plan an event like the Christmas fair (or just volunteering to run a stall), baking buns, designing posters and programmes for events, first aiders for the discos, selling ice creams after school on a Friday
- ✓ Come to meetings to discuss how funds can be spent
- ✓ Every little bit of help people can offer really does add up. If you're interested and would like more information, then please contact [hnpstpa@gmail.com](mailto:hnpstpa@gmail.com)



[www.pta-events.co.uk/newlaites](http://www.pta-events.co.uk/newlaites) — sign up

<https://www.facebook.com/groups/191373841012813/> or search 'Horsforth Newlaites PTA'

[hnpsta@gmail.com](mailto:hnpsta@gmail.com) — email us

**THANK YOU, YOUR PTA COMMITTEE**